

9.2 FA and RW axes

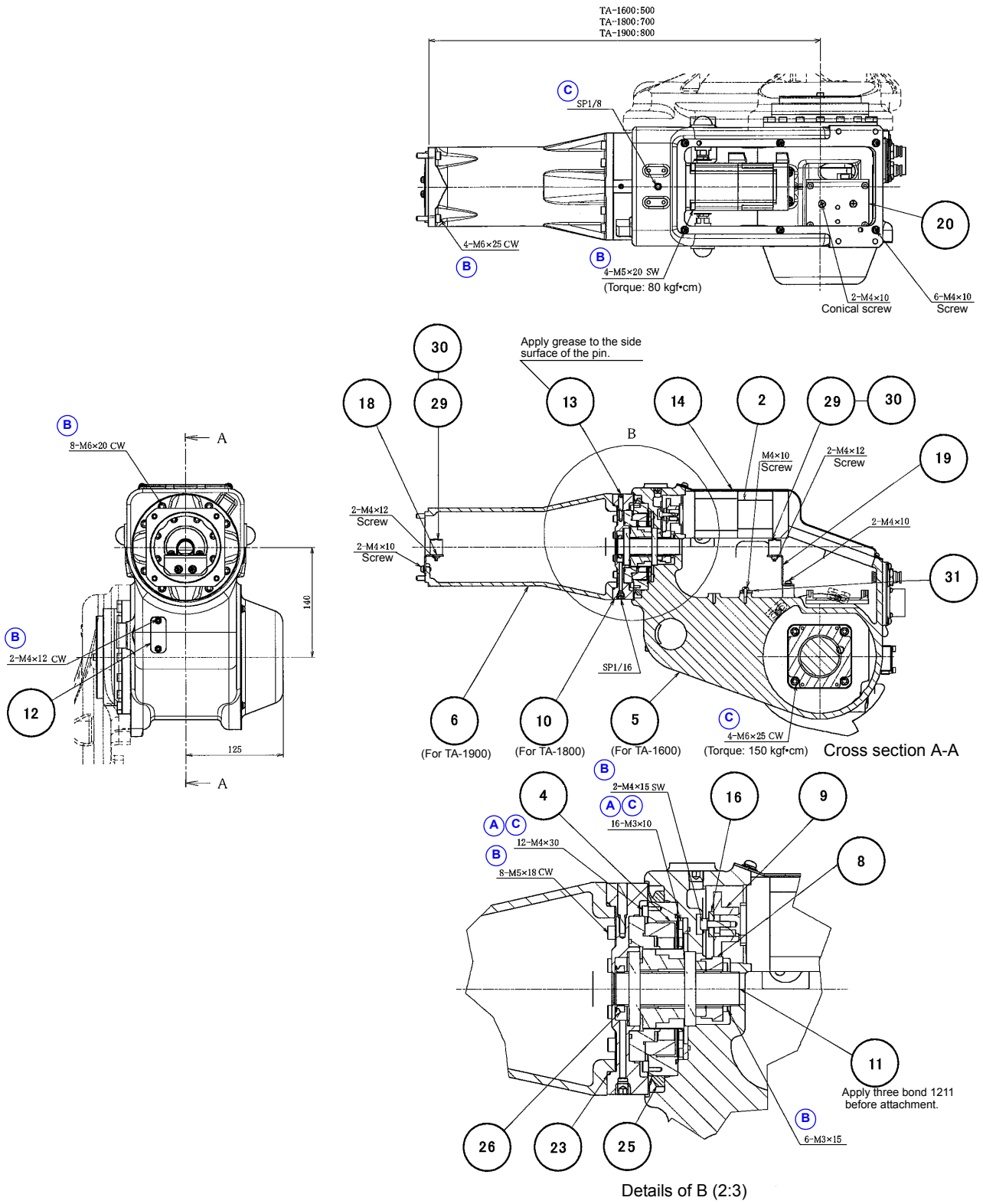

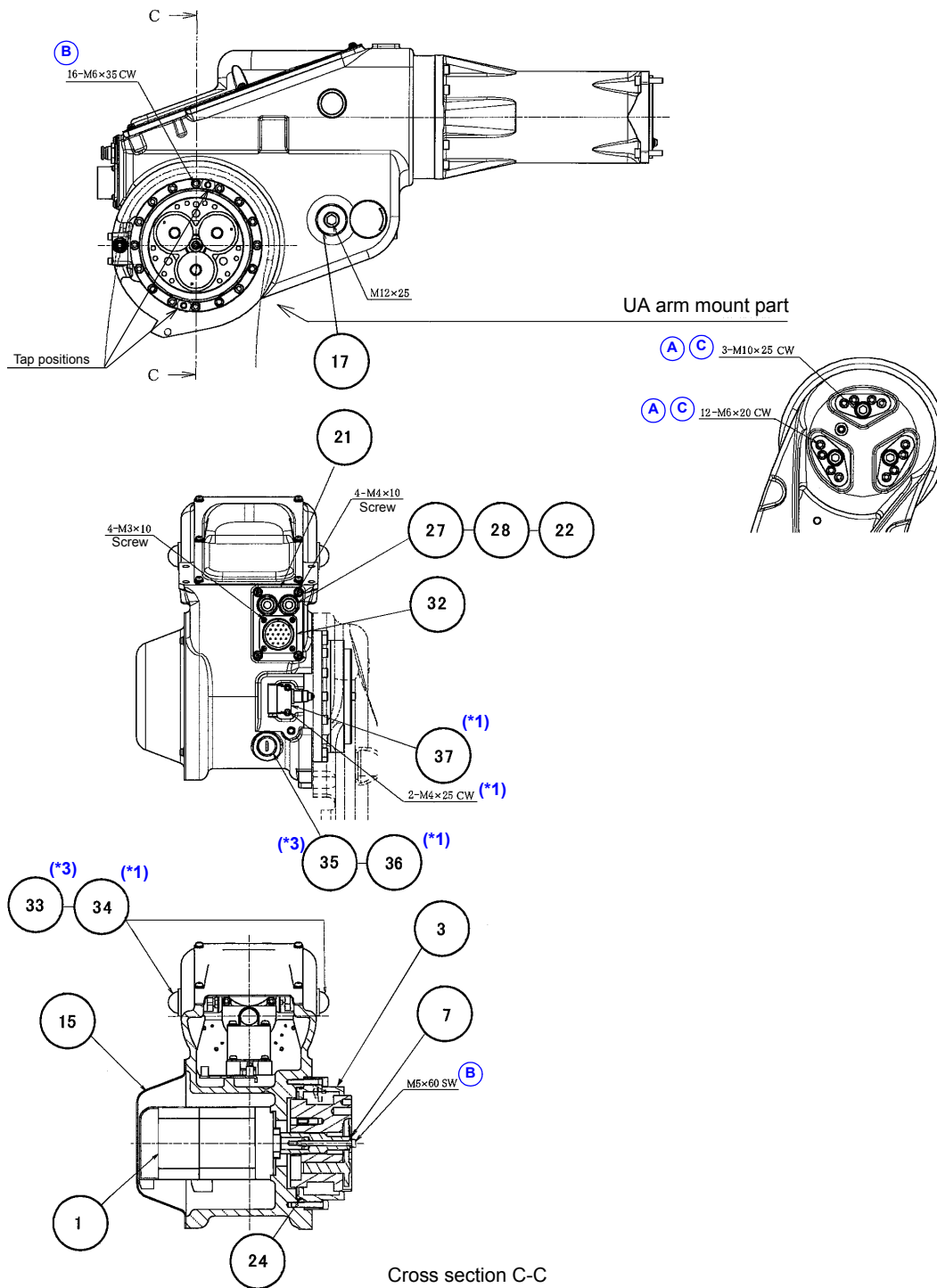

**Note**

- (\*1) It is used for UL spec. of YA-1Q/YA-1R series.
- (\*2) It is used for CE spec. of YA-1Q/YA-1R series.
- (\*3) It is used for standard spec. of YA-1Q/YA-1R series.

## Assembly drawings

No.	Part name	Part number	Q'ty	Note	Class
1	Servo motor	TS4614N8323	1	FA axis	C
2	Servo motor	TS4609N8323	1	RW axis	C
3	RV25E reduction gear	28E045-1	1	FA axis	C
4	Harmonic	HG2080RR81R	1	RW axis	C
5	RW body	ADA11094-03	1		D
6	Joint arm	ADA21045	1	TA-1600	D
		ADA21048	1	TA-1800	D
		ADA21049	1	TA-1900	D
7	Input gear R25	ADG32012-01	1		B
8	Input gear H20	ADG41082	1		B
9	Pinion gear H20	ADG41081-01	1		B
10	Output flange	ADH32024	1		D
11	RW inner tube	AGG41059	1		D
12	FA harness fixer	AFS41021	1		D
13	CAL pin M4	AAG41005	1		C
14	RW motor cover	ADK32025	1		D
15	FA motor cover	ADK41058	1		D
16	Motor collar 022	AFM410217	1		D
17	Stopper 1	ABQ41008	1		D
18	RW harness holder 1	AFP41187	1		D
19	RW harness holder 1	AFP41188	1		D
20	F card holder 1	AFP41183-01	1		D
21	Option metal plug	AKK41153TA01	1		D
22	O-ring	S16	2		A
23	O-ring	S100NBR	1		A
24	O-ring	S120	1		A
25	V-ring	V110A	1		A
26	V-ring	V22A	1		A
27	Bucklehead union	PM8	2		D
28	O-ring holder	AGP40016	2		D
29	PLICA saddle	SP15N	2		D
30	Rubber sheet	AFQ40143	4	For fixing TWBW harness	D
31	Nylon clamp	NK11N	1		A
32	R gasket	P100842-22	1		D
33	Hole plug	CP30HP11	2	T/Y types only	D
34	Indicator lamp	DM22K0LE03Y	2	U types only	A
35	End cap	514/11	1	T/Y types only	D
36	Cable grand	PGA11-10G	1	U types only	D
37	Limit SW ass'y	AEB31006	1	U types only	A

<Class> A: Consumable parts, rather short replacement cycle.

B: Assemblies and parts of high frequency in motion.

C: Important electric parts.

D: Parts rather long replacement cycle.